

CENTRA Active®

Instruction Manual for
CENTRA Active Hearing Instruments



Siemens Hearing Instruments

SIEMENS

Table of contents

Your CENTRA Active® hearing instruments	1
Inserting and removing CENTRA Active	3
Turning your instrument on and off	4
Handling standard and rechargeable batteries ...	5
Using the charger	11
Using the domes	12
Using the clip-on cover	15
Replacing the receiver unit	17
e2e wireless® and ePocket®	19
Maintenance and care	22
Identification information	23
Important notes.....	25
Troubleshooting tips	26

Your CENTRA Active™ hearing instruments

Siemens CENTRA Active hearing instruments are designed for comfort and performance in a virtually invisible style (when worn). CENTRA Active offers an assortment of receiver lengths and dome sizes to best fit your ear. Your instrument will look similar to the following illustration (Fig. 1).

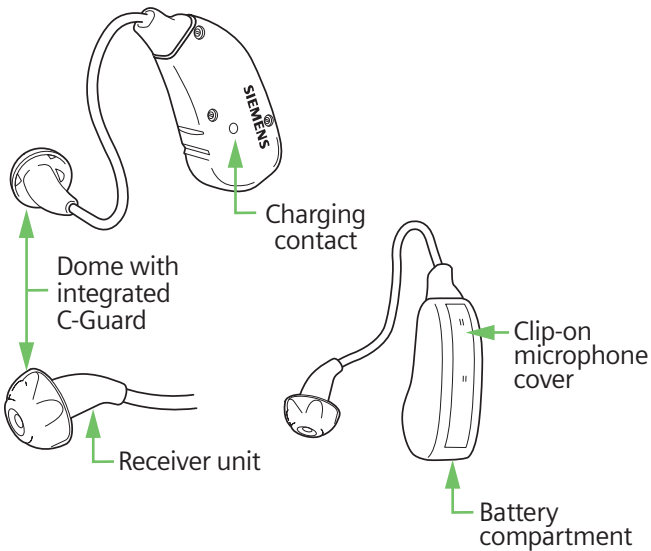

Fig. 1: Location of features

Important notes:

Always wear the receiver unit with the dome.

Make sure that the dome is completely attached to the receiver unit.

If the dome remains in the ear after removal of your hearing instrument, have it removed by a medical professional.

Replace the dome if it breaks.

Do not insert the receiver and dome too deeply in your ear. Speak with your Audiologist or Hearing Care Provider for further explanation.

Inserting and removing CENTRA Active

To insert the hearing instrument, make sure it is turned off by opening the battery compartment to the first stop. Hold the receiver with the dome between your thumb and index finger and insert it carefully into the ear canal (Fig. 2).

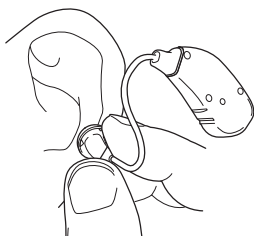

Fig. 2: Inserting the instrument

You may find it helpful to pull your ear slightly upward or backward when inserting your instrument.

Then place the instrument behind your ear and turn it on, by completely closing the battery compartment.

To remove your hearing instrument, hold the receiver unit between your thumb and index finger and carefully pull it out.

Note: Do not use a lubricant to insert the receiver unit, as it may clog the sound outlet.

Turning your instrument on and off

To turn on your instrument, fully close the battery compartment (Fig. 3).

To turn off the instrument, press the battery compartment downward to the first stop (Fig. 3).



Fig. 3: Turning your instrument on and off

Power-on delay

Your CENTRA Active hearing instrument is equipped with a power-on delay feature which can be activated by your Audiologist or Hearing Care Provider. This feature allows you to turn the hearing instrument on with an automatic delay of 12 seconds, so that you may insert the hearing instrument into your ear without experiencing unpleasant feedback (whistling).

Handling standard and rechargeable batteries

You can use either a standard or a rechargeable battery in your CENTRA Active hearing instrument. The optional CENTRA Active charger is required to charge rechargeable batteries.

Always use a size 13 battery.

If using a standard battery, remove the backing tab only when you are ready to use it.

If using a rechargeable battery, charge it before the first use.

Inserting the battery

To insert the battery into the hearing instrument, open the battery compartment with your fingernail as shown (Fig. 4).

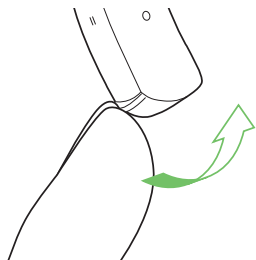

Fig. 4: Inserting the battery

Swivel open the battery compartment door. Insert the proper size battery into the compartment door so that the "+" symbol on the battery coincides with the "+" marked on the battery compartment (Fig. 5).

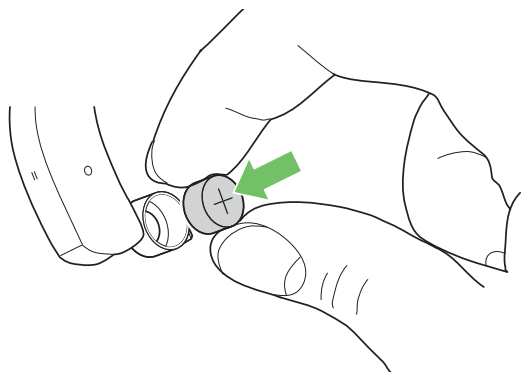

Fig. 5

Close the battery compartment by gently pressing the bottom of the door upward with your fingertip. Do not force the door shut. If it does not close easily, check to ensure the battery was inserted properly (Fig. 6).

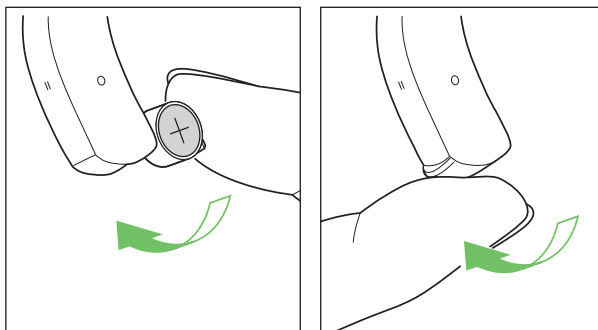

Fig. 6

Removing the battery

The battery should easily drop out when the compartment door is completely open (Fig. 7). If the battery does not come out, lightly tap on the case.

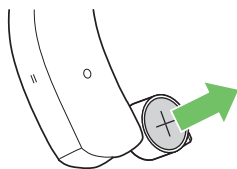

Fig. 7: Removing the battery

Low battery indicator

Your hearing system may be programmed to inform you when the battery should be replaced. If you hear an intermittent series of beeps or experience low amplification volume or power, replace the battery.

Change the batteries or recharge them when any of the following occurs:

- Volume of your instrument becomes softer or weak
- Beeps signaling a low battery
- ePocket display shows empty battery status

WARNING: Choking hazard posed by small parts.

- Keep hearing instruments, batteries and accessories out of reach of children.
- If swallowed consult a physician or a hospital immediately.
- If infants, small children or mentally disabled persons need to wear hearing instruments, ensure adequate supervision.

Battery tips

CAUTION! Batteries can be harmful if swallowed.

- If a battery is accidentally swallowed, seek medical attention immediately, or call **The National Button Battery Hotline collect at (202) 625-3333.**
- Always use the battery size recommended on your warranty card, or by your Audiologist or Hearing Care Provider, for your model for best performance.
- Remove the battery from your instrument when not in use. This prevents possible damage from expansion or leakage of the battery, if the instrument is not fully turned off.
- Always carry spare batteries in the event that your current battery goes dead. Place each spare battery in an individual, non-metallic container to prevent contact with other batteries or metal objects, such as keys or coins.
- Follow your local recycling rules for battery disposal.

*Note: Do not throw used batteries into household trash.
Return them to your Audiologist or Hearing Care
Provider for environmentally correct disposal.*

WARNING: Risk in explosive environments, e.g., mining areas!

- Don't use your hearing instruments (and remote control) in areas where there is a danger of explosions.

Using a remote control

If you have an optional ePocket® remote control, the battery status can be checked using the "battery read out" function. For further information on the ePocket, speak to your Audiologist or Hearing Care Provider or refer to the ePocket instruction manual.

Using the charger

If you have the CENTRA Active optional charger, refer to the charger instruction manual for operating instructions. Use only the rechargeable batteries with your CENTRA Active instrument that are delivered with the charger or available through your Audiologist or Hearing Care Provider. The lifetime of a rechargeable battery is approximately one to two years, depending on individual use.

NOTE: Do not attempt to charge standard, non-rechargeable batteries!

Using the domes

The dome includes a C-Guard[®] integrated wax protection system. Cerumen (ear wax) that has built up externally on the dome can be removed easily with a soft tissue (Fig.8). For best results, it is recommended that you change your dome approximately every three months, or as needed.

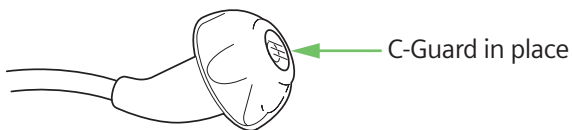

Fig. 8: Using the domes

Cleaning instructions

Cerumen (ear wax) on the dome may affect sound quality. Listen for any changes in how your hearing instrument is performing. If wax has built up, it can be easily removed with a soft tissue or dry cloth (Fig. 9). Do not use water, alcohol, benzene or any other liquid or household cleaning agent or liquid to clean your instruments or domes, as it may cause damage.

Note: Never use brushes or sharp objects for cleaning, as they may damage the dome or C-Guard. Never use running water or immerse the instrument in water. Never use pressure or rotating action while cleaning.

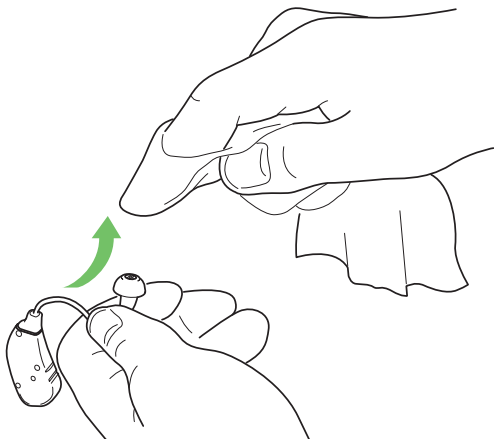

Fig. 9: Cleaning the dome

Replacement of the dome

Gently pull on the rim of the dome to remove it from the instrument (Fig.10).

To attach a new dome, take the box of domes and, without removing the dome, place the receiver unit over one of the domes. Gently push down over the new dome until the edge of it covers the

white line (Fig. 11). Remove the receiver and new dome which are now attached (Fig. 12).

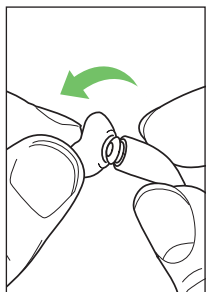

Fig. 10

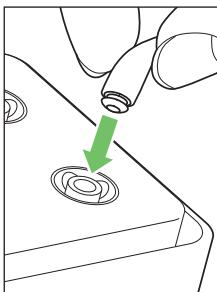

Fig. 11

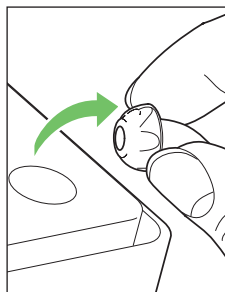

Fig. 12

Caution: Do not place the receiver in your ear without the dome.

Warning: If the dome becomes detached in your ear, contact your Audiologist or Hearing Care Provider or physician immediately.

Using the clip-on cover

The clip-on cover is a barrier that protects the microphones from sweat, humidity, and moisture. Change the clip-on cover when sound is diminished or the clip-on cover is soiled.

To remove the clip-on cover, open the battery compartment and lift the clip-on cover with your fingernail. It will slide open (Fig. 13).

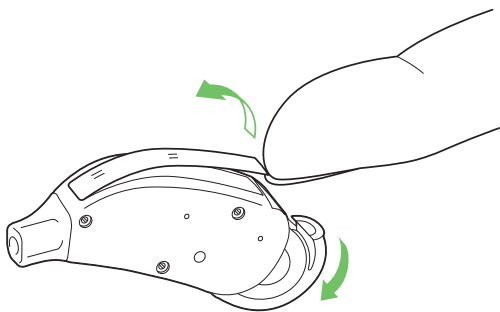

Fig. 13: Removing the clip-on cover

To insert the clip-on cover, hold the new cover with the two pins at the upper end and clip it into the housing. It is recommended that you change the clip-on cover every three months, or as needed (Fig. 14). If you need assistance changing the cover, see your Audiologist or Hearing Care Provider.

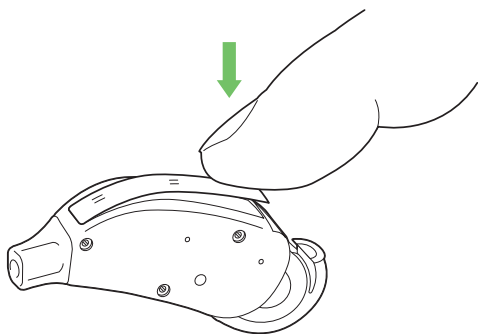

Fig. 14: Inserting the clip-on cover

Note: Change the cover only when necessary to avoid accidentally damaging it.

CAUTION: The clip-on cover can be damaged if bent too far during removal.

Replacing the receiver unit

The receiver unit can be changed as needed by your Audiologist or Hearing Care Provider. If the receiver becomes detached from the instrument carefully follow these instructions to reattach it or contact your Audiologist or Hearing Care Provider.

Note the red mark on the white ring at the tip of the CENTRA Active instrument at the 10 o'clock position (Fig 15). Place the receiver unit down into the opening at the 10 o'clock position, lining it up with the red mark (Fig 16). Turn the receiver gently to the right until you feel a small click in the 12 o'clock position (Fig 17). The receiver is now mounted correctly.

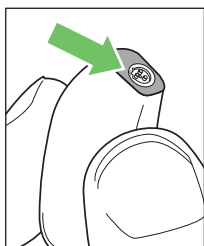

Fig. 15

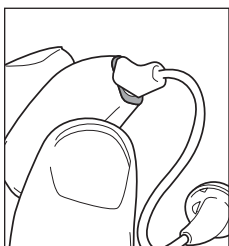

Fig. 16

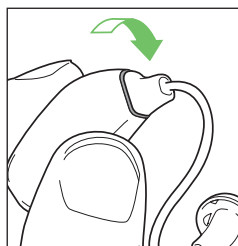

Fig. 17

It is not recommended to remove the receiver unit for everyday use. Your Audiologist or Hearing Care Provider will change the receiver unit as needed.

Health considerations

If soreness or skin irritation develops, discontinue wearing your hearing instrument, and bring the instrument (including dome) to your Audiologist, Hearing Care Professional or Medical Professional. Minor fit adjustments can often correct this condition. If soreness persists, discontinue wearing the hearing instrument and see your physician.

e2e wireless and ePocket

e2e wireless provides synchronization in CENTRA Active hearing instruments if you are wearing two hearing instruments. The wireless functionality also enables use of an optional ePocket remote control. If you change the memory or volume on one instrument, the other is automatically changed. In addition, e2e wireless technology automatically adjusts the system to change both hearing instruments simultaneously to adapt to different listening situations.

Your Audiologist or Hearing Care Provider can provide more information on the wireless functionality of your CENTRA Active hearing system.

Note: The performance of the e2e wireless could be temporarily affected when in close proximity to electromagnetic noise sources, such as a computer monitor or television. Move away from the noise source if you experience difficulty.

WARNING: Pacemaker compatibility

Siemens remote control devices have been tested and found not to cause interference with cardiac

pacemakers that are manufactured and operated in compliance with applicable safety standards, provided a minimum distance of 12 inches (30cm) is maintained between the remote control and the pacemaker. To accommodate this provision:

- Do not activate the remote within 12 inches of the pacemaker.
- Do not carry the remote in your breast pocket.
- Do not wear the remote with a lanyard around your neck.
- Do not place remote directly on the skin over the implanted pacemaker.

Following these precautions, Siemens remote controls can be operated safely by, or within the vicinity of, individuals fitted with these pacemakers.

ePocket remote control

An optional ePocket remote control is available for your CENTRA Active hearing system. ePocket can be used to change the memory and volume of your hearing instrument, as well as read out the system settings without having to manually adjust the hearing instruments.

For further information on the ePocket, speak to your Audiologist or Hearing Care Provider or refer to the ePocket instruction manual, if applicable.

Below is a list of listening environments programmed into your CENTRA Active hearing instrument.

Memory number	Listening environment
1	_____
2	_____
3	_____

Maintenance and care

Wipe your instruments with a clean, dry cloth. Do not use water, alcohol, benzene or any other liquid or household cleaning agent or liquid to clean your instruments or domes, as it may cause damage.

Never immerse your hearing instruments in water!

For further instructions on cleaning and maintenance, consult your Audiologist or Hearing Care Provider.

Identification information

Your hearing instruments have a serial number engraved on them. The location of the serial number will vary according to the style of hearing instrument you have chosen.

The year of manufacture is incorporated into the serial number (Fig. 18). Please note the warranty is based upon the date of purchase, not the date of manufacture. The serial number may look similar to this sample: AS12345. The second letter of this serial number refers to the year of manufacture of the hearing instrument. The letters S or T indicate a 2008 year of manufacture. Your Audiologist or Hearing Care Provider can answer any questions you may have about the identifying code on your hearing instrument.

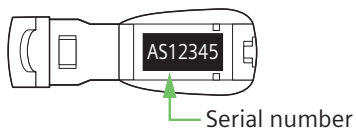

Fig. 18: Identification information

Record the serial numbers of each instrument in the space provided for future reference.

Serial numbers:

Left ear: _____

Right ear: _____

Important notes

As with all electrical, non-gas-encapsulated systems, the hearing instrument should not be operated in rooms where there is a danger of explosion.

Do not wear your hearing instruments during short-wave therapy, or in conjunction with medical treatments that use a strong magnetic or high-frequency fields, such as X-rays.

Never expose your hearing instruments to extreme temperatures. Do not store in direct sunlight.

Make sure to turn off the instrument when not in use. This helps to preserve battery life. When not wearing your instruments for long periods of time, remove the batteries to prevent leakage.

Troubleshooting tips

Should a problem occur with your CENTRA Active hearing instruments, it can usually be corrected quickly. The troubleshooting tip chart below can help you identify possible problems and solutions.

Problem	Cause	Possible Solution
Sound is weak	Weak or dead battery	Insert new standard battery or charge rechargeable battery
	Instrument clogged	Clean or change dome
	Volume too low	Clean or change dome
	Dome clogged with wax or debris	Clean or change dome
	Microphone cover clogged	Change Microphone Cover
Instrument emits whistling sound	Improper seating in ear	Try reinserting the receiver until it fits securely
	Volume too high	Lower volume with the ePocket
	Clogged with wax or excessive wax in ears	Clean tip or contact your Audiologist or Hearing Care Provider
	Battery compartment not completely closed	Gently close the battery compartment completely
	Weak battery	Charge or replace battery
Sound is distorted	Volume too high	Lower volume with the ePocket
	Weak battery	Charge or replace battery
Instrument does not work	Instrument not turned on	Turn instrument on
	Battery compartment not completely closed	Gently close the battery compartment completely
	Dead battery	Charge or replace battery
	Battery polarity reversed	Make sure battery is inserted correctly
	Power-on delay is active	Wait 15 seconds and check again

IC: 267AB-WL001

This device complies with Part 15 of the FCC Rules. Operation is subject to the following two conditions: (1) this device may not cause harmful interference, and (2) this device must accept any interference received, including interference that may cause undesired operation.

Changes or modifications not expressly approved by the party responsible for compliance could void the user's authority to operate the equipment

Your Audiologist or Hearing Care Provider:

Siemens Hearing Instruments, Inc.

P.O. Box 1397

Piscataway, NJ 08855-1397

www.usa.siemens.com/hearing

Information in this manual subject to change without notice.

Copyright © 2008 Siemens Hearing Instruments, Inc. All Rights Reserved

10170509 10/08 3.0 22S150 6K
SHI/09937-8