

CENTRA[®]

**Instruction Manual for
CENTRA[®] In-the-Ear,
Half Shell and In-the-Canal
Hearing Instruments**

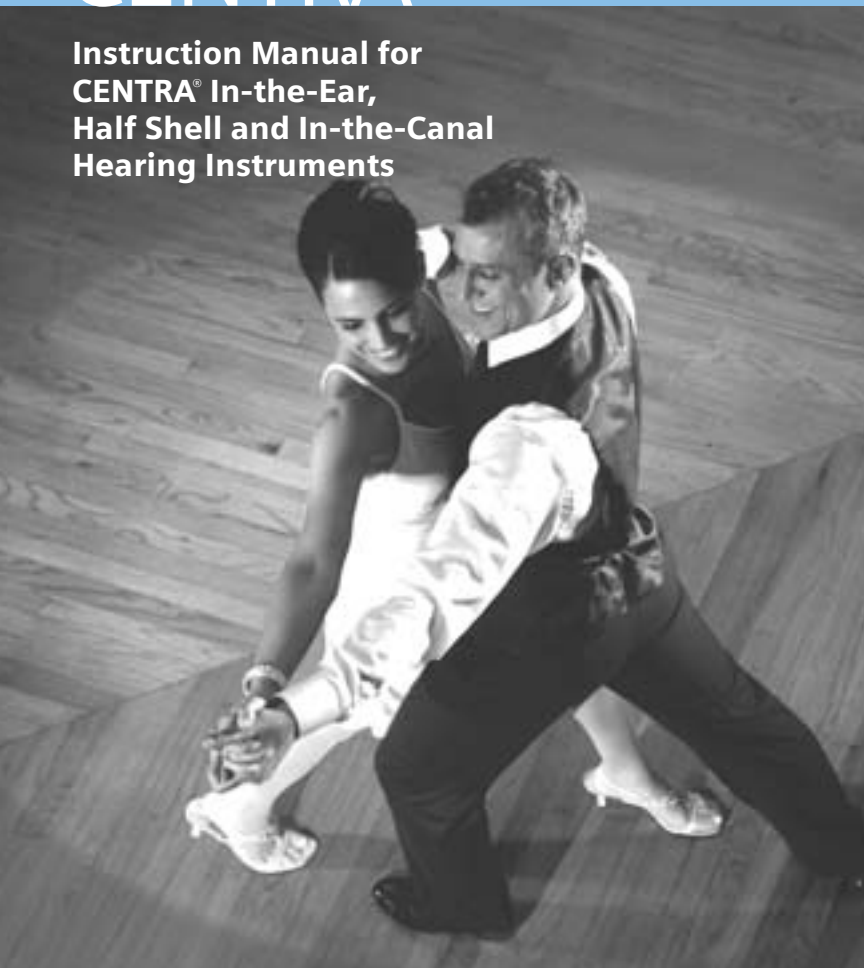

Siemens Hearing Instruments

SIEMENS

Your CENTRA® Hearing Instruments

Your CENTRA® hearing instrument is custom-made to fit the contours of your ear. Each instrument can be identified by a serial number found on the outside of the instrument. If the number appears in red, this hearing instrument is for the right ear. If the number appears in blue, this hearing instrument is for the left ear.

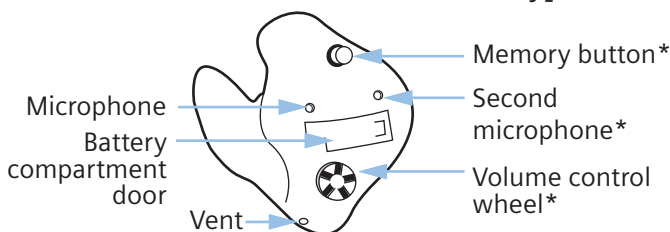
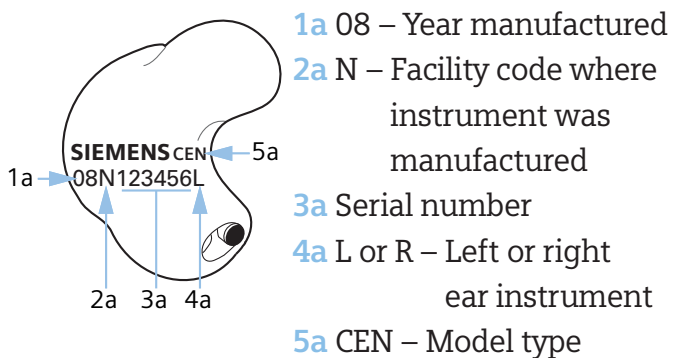

Fig. 1: Left ITE hearing instrument

1b 08 - Year manufactured

2b N - Facility code where instrument was manufactured

3b Serial number

4b L or R - Left or right ear instrument

5b CEN - Model type

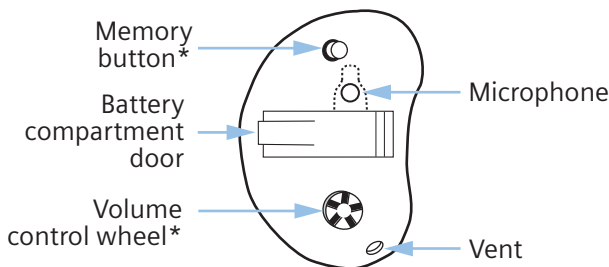
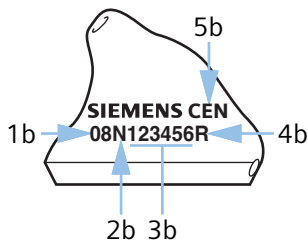

Fig. 2: Right HS/ITC hearing instrument

**The model shown indicates a memory button, volume control wheel and one or two microphones. Your Audiologist or Hearing Care Provider will determine whether it is necessary to include any or all of these options on your hearing instrument.*

Because your hearing instrument was custom-made, its appearance may vary from the one pictured.

The battery compartment door holds the battery that powers the instrument. The vent hole, which can appear in various locations, provides comfort and pressure release.

Inside your hearing instrument, the microphone, analog-to-digital converter, digital signal processor receiver and other specialized components process sound that is directed to the eardrum and auditory system.

The microphone picks up sound waves from the air and converts them to electrical signals. The analog-to-digital converter encodes the electrical signals into a format that is usable by the digital signal processor.

The digital signal processor has been programmed by your Audiologist or Hearing Care Provider to execute the required digital signal processing for your particular hearing loss.

The receiver converts the digitally processed signal directly back into sound waves.

Using your CENTRA hearing instrument

Battery size

The chart below provides the battery size generally used in your hearing instrument. However, since your hearing instrument is a custom product, it's recommended that you check with your Audiologist or Hearing Care Provider regarding the correct battery for your instrument.

<u>Model</u>	<u>Size</u>
CENTRA In-the-Ear	312
CENTRA Half Shell	312
CENTRA In-the-Canal	312

Before using your hearing instrument, place the battery into the battery compartment door. Using the fingernail of either your thumb or index finger, pull the tab on the battery compartment door outward until the door swings open all the way (Fig. 3).

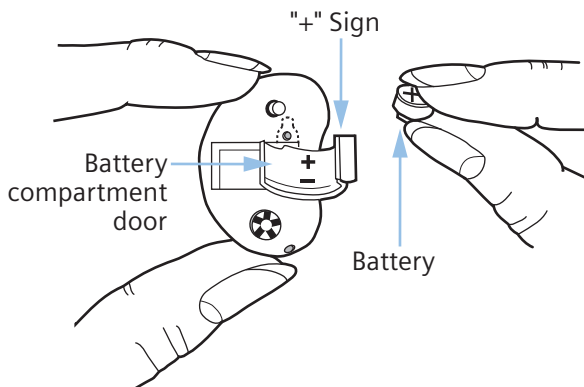

Fig. 3: Opening the battery compartment

Place the proper size battery (see "Battery" section or consult your Audiologist or Hearing Care Provider) into the battery compartment door, observing the correct polarity. The "+" sign on the battery must match the "+" sign stamped on the top of the battery compartment door (Fig. 4).

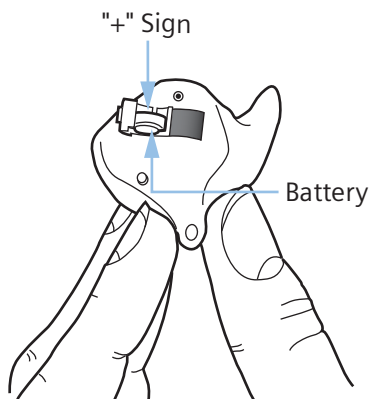

Fig. 4: Inserting the battery

Gently close the battery compartment door. Avoid forcing the door shut. If it does not close easily, check to see if the battery was inserted properly. Once the battery is in its proper position, your instrument is ready to operate.

Note: Make it a habit to remove the battery every time you take off your hearing instrument.

Low battery indicator

Your hearing instrument may be programmed to inform you when the battery should be replaced for best performance. If this feature is activated in your hearing instrument, you may hear two long, low pitched beeps and/or experience low amplification power or volume. Change the battery immediately when either of these occur.

If you have an optional ePocket® remote control, the battery status can also be checked using the "Data Read Out" function. (See the ePocket instruction manual or your Audiologist or Hearing Care Provider for more information.)

WARNING: Choking hazard posed by small parts.

- Keep hearing instruments, batteries and accessories out of children's reach.
- If swallowed consult a physician or a hospital immediately.
- If infants, small children or mentally disabled persons need to wear hearing instruments, ensure adequate supervision.

Battery tips

CAUTION! Batteries can be harmful if swallowed.

- If a battery is accidentally swallowed, seek medical attention immediately, or call **The National Button Battery Hotline collect at (202) 625-3333.**
- Always use the battery size for your model recommended on your warranty card or by your Audiologist or Hearing Care Provider.
- Remove the battery from your instrument when not in use. This prevents possible damage from expansion or leakage of the battery, if the instrument is not fully turned off.
- Always carry spare batteries in the event that your current battery goes dead. Place each spare battery in an individual, non-metallic container to prevent contact with other batteries or metal objects, such as keys or coins.

- Follow your local recycling rules for battery disposal.

Note: Do not throw used batteries into household trash. Return them to your Audiologist or Hearing Care Provider for environmentally correct disposal.

WARNING: Risk in explosive environments, e.g. mining areas!

- Don't use your hearing instruments (and remote control) in areas where there is a danger of explosions.

Inserting and removing the hearing instrument

Hold the instrument between your thumb and index finger. With the face of the instrument toward the outside, place the canal portion into your ear. Gently work the instrument into its proper position by slightly twisting until it is firmly seated. Lightly press inward for a secure and comfortable fit (Fig. 5).

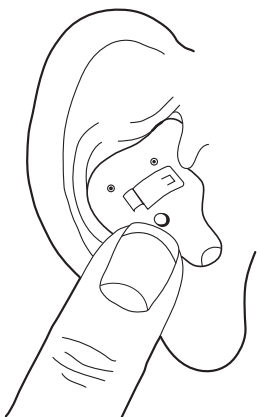

Fig. 5: Inserting the hearing instrument

To remove the hearing instrument, push lightly on the back of the ear to help loosen it. Then, using your index finger, carefully pull the hearing instrument from your ear.

CAUTION! Never pull on the battery compartment door to remove the instrument, as this could cause damage.

Turning the hearing instrument on or off

Using the battery door, insert a battery into the hearing instrument and close the door to turn the instrument on. To turn the instrument off using the battery door, open the battery compartment door completely.

Your hearing instrument may also be programmed to allow you to turn it on and off using the memory button. To turn the instrument off using the memory button, press and hold the button for 3 – 5 seconds. To turn the instrument back on, press and hold the memory button for 3 – 5 seconds.

Please note that after having turned the instrument off using the memory button, you must wait approximately 10 seconds for the system to reset before turning it back on again by using the memory button.

Check with your Audiologist or Hearing Care Provider about which on/off functions are available on your hearing instrument.

Power-on delay feature

Your hearing instrument may be equipped with an advanced power-on delay feature. This feature delays sound from entering your hearing instrument when it is first turned on, so that you may insert the instrument into your ear without experiencing unpleasant feedback (whistling).

e2e wireless®

Your CENTRA hearing instrument has e2e (ear-to-ear) wireless® technology. e2e wireless provides synchronization of the settings in the hearing system when wearing two CENTRA hearing instruments. If you change the volume or memory on one instrument, the other is automatically changed. In addition, e2e wireless technology automatically adjusts the system to change both hearing instruments simultaneously to adapt to different listening situations. The wireless functionality also allows use of an optional ePocket remote control.

Your Audiologist or Hearing Care Provider can activate or deactivate the wireless functionality of your hearing instrument.

Note: The performance of the e2e wireless could be temporarily affected when in close proximity to electromagnetic noise sources, such as a computer monitor or television. Move away from the noise source if you experience difficulty.

ePocket® remote control accessory

An optional ePocket remote control is available for all CENTRA hearing instruments. ePocket can be used to change the memory and volume of your hearing system as well as read out the instrument settings without having to manually adjust the hearing instruments.

For further information on the ePocket, speak to your Audiologist or Hearing Care Provider or refer to the ePocket instruction manual, if applicable.

Using the memory button

Your CENTRA hearing instrument may have up to 4 memories, also called hearing programs, which are selected with the memory button or ePocket remote control. Each program is different and designed to help you hear better in specific listening situations.

When initially turned on (after the battery compartment door is closed) the microphone is ON and ready for general use, the default is Memory 1. Your Audiologist or Hearing Care Provider will provide you with the number of memories most appropriate for your needs. Each time you press the memory button on the hearing instrument or the "P" button on the ePocket, your CENTRA hearing instrument changes to the next memory. The memory change may be confirmed by alerting tones or beeps which correlate to the memory you are in. That means if you select Memory 3, then the hearing instrument beeps 3 times.

If you are wearing two hearing instruments, your Audiologist or Hearing Care Provider can program them so that the program will be changed on both instruments at the same time when you press either the memory button, or the "P" button on the ePocket.

Below is a list of listening environments programmed into the memories of your hearing instrument.

Memory number	Listening environment
1	_____
2	_____
3	_____
4	_____

If no memory button is provided, your Audiologist or Hearing Care Provider will program the instrument to automatically adjust to a wide variety of listening environments without any effort on your part.

Using the directional microphone system (where provided)

According to your hearing needs, the hearing instrument can be adjusted to focus on those sounds in front of you (directional mode) for when you are having a face-to-face conversation in a noisy environment. The hearing instrument can also be adjusted for when you are in more quiet environments and want to hear the sounds around you (omnidirectional mode).

Your Audiologist or Hearing Care Provider will program the operation of the directional microphone system either automatically or in conjunction with the memory button based upon your particular hearing requirements. Unless programmed to be automatic, you select between the directional and omnidirectional modes by pushing the memory button on the hearing instrument or by using the ePocket.

Volume Control

Your CENTRA hearing instrument is fully automatic. There is no need to manually adjust the volume control. However, if you prefer manual volume control, your CENTRA hearing instrument can be programmed for manual adjustments, too.

If your instrument is programmed for manual adjustment, the wheel-shaped volume control on the hearing instrument can be rotated forward or backward. The volume up (+) and down (-) buttons on the ePocket can also be used to select the most desired listening position (louder or softer).

To increase the volume, place your index finger gently against the volume control wheel and rotate it forward or use the volume up button on the ePocket. To reduce the volume, rotate the wheel in the opposite direction or use the volume down button on the ePocket. Once the volume maximum or minimum has been reached, further changes to the volume in that direction will have no effect.

If you are wearing two hearing instruments, your Audiologist or Hearing Care Provider can couple the controls, so that the volume of both instruments will change at the same time when you adjust the volume control wheel or change the volume with the ePocket.

You may hear soft beeps each time you change the volume, and a three-beep warning when the volume limit has been reached. These tones can be enabled or disabled by your Audiologist or Hearing Care Provider.

If your hearing instrument has not been programmed for manual control adjustment, the volume will adjust automatically and rotating the volume control wheel will have no effect.

Learning volume preference feature (where provided)

The learning volume preference feature retains information on when and how you adjust the volume on your CENTRA instruments programmed for manual adjustment. Over time, your CENTRA hearing instruments will automatically adjust to your preferred volume in each listening program. For more information about this feature, speak with your Audiologist or Hearing Care Provider.

Using the telephone

You may use the telephone in a natural manner. If you get a whistling sound (feedback), tilt the phone receiver away from your ear and/or reduce the volume until the whistling stops. By trying various positions of the telephone receiver, you will discover what works best for you.

Telecoil feature (where provided)

Your hearing instrument may be equipped with a T-coil (telecoil) switch, a special feature designed for when you're listening on the telephone. Ask your Audiologist or Hearing Care Provider how to adjust it during phone use.

Note: This requires your telephone to be "hearing aid compatible." Check your telephone's instruction manual to determine whether your telephone has this capability.

If you are using an ePocket remote control, be sure to change your listening program out of T-coil mode before using the "Data Read Out" function. Using the "Data Read Out" function while in T-coil mode will cause a loud pulsing noise to be heard, due to pickup of the transmission signal of the T-coil.

Automatic telecoil feature (where provided)

The AutoPhone option allows the telecoil to automatically switch on when a "hearing aid compatible" telephone handset is brought close to the hearing instrument. To operate, bring the telephone handset close to the hearing instrument. The telecoil will automatically engage to the presence of the electromagnetic signal from the telephone. When you are finished speaking on the phone, move the handset away from the hearing instrument and the microphone mode will re-establish itself.

AutoPhone magnet accessory

There is an AutoPhone magnet accessory available for your telephone that can be used with the AutoPhone feature of your hearing system. Ask your Audiologist or Hearing Care Provider about this accessory and if it is appropriate for your individual hearing care needs.

Note: When magnets are properly cared for, they are safe to use and can last a lifetime. However, the following guidelines should be followed while using these magnets. Magnets can pose risks to electronics and magnetic storage media when placed in close proximity. Be careful not to place magnets near computers, color monitors, television sets, floppy disks, video/audio tape, and other electronic equipment. Magnets may interfere with the operation of life support systems, such as pacemakers, magnetic valves, etc. Make certain to maintain a distance of at least four inches between the magnet and the area of your support system. Keep magnets out of the reach of children or pets. If accidentally swallowed, seek medical attention.

Health considerations

If soreness or skin irritation develops in the ear, discontinue wearing your hearing instrument, and bring the instrument to your Audiologist or Hearing Care Provider. Minor fit adjustments and polishing can often correct this condition.

If soreness persists, discontinue wearing the hearing instrument and see your physician.

If excessive earwax accumulates when wearing your hearing instrument, consult your Audiologist or Hearing Care Provider.

Maintenance and care

Always store your hearing instrument inside its case. A soft carrying pouch is also included for your convenience when traveling.

Never immerse your hearing instruments in water!

If needed, your CENTRA hearing instruments can be wiped with a tissue or other clean, dry cloth.

IC: 267AB-WL001

This device complies with Part 15 of the FCC Rules. Operation is subject to the following two conditions: (1) this device may not cause harmful interference, and (2) this device must accept any interference received, including interference that may cause undesired operation.

Changes or modifications not expressly approved by the party responsible for compliance could void the user's authority to operate the equipment.

Your Audiologist or Hearing Care Provider:

Siemens Hearing Instruments, Inc.

P.O. Box 1397

Piscataway, NJ 08855-1397

www.usa.siemens.com/hearing

Information in this manual subject to change without notice.

Copyright © 2008 Siemens Hearing Instruments, Inc. All Rights Reserved.